





100  
0 10  
Millimetres



**P1.2/P3.1**  
Banwell Conservation Area

**E2.1, LE6.4**  
Pond 6 Attenuation basin with species rich marshy grassland

**LE2.2**  
Woodland edge planting providing filtering of views and reinforcing landscape boundaries and character.

**LE7.5**  
Dark Lane/Castle Hill stopped up. Pedestrian access provided via steps from Dark Lane to Cattle Hill. Equestrian access only via Castle Hill.

**LE5.2**  
Bat hopover to guide flightline

**LE4.4**  
Hedgerow with intermittent hedgerow trees, screening southerly views from former A368. Placemaking, enhancing townscape setting and visual connectivity with Banwell Wood.

**E3.2**  
Attenuation basin surrounds to include habitat piles and refugia suitable for reptiles.

**E3.2 LE2.1**  
Protected species fencing. Biodiversity enhancement - fruiting component in planting.

**P 4.1**  
Location for Main site compound. Reinstate and return to agriculture.

**P1.2**  
Tree Preservation Order

**FOR CONTINUATION REFER TO DRAWING BNWLB-P-ARP-ELS-X\_BB\_Z-DR-LE-000015**

**LE1.3 LE2.1 LE4.4**  
Hedgerow and hedgerow trees boundary. Woodland block planting, species rich grassland. Habitat creation, foraging and roosting potential, pollinators setting for eastern A368 tie in.

**E3.2 LE4.4**  
Natural hop over the road for bats/SAC - strengthen planting on east side for bat mitigation.

**LE5.2**  
Bat hopover to guide flightline

**E1.2**  
Noise barrier - Built element. Fencing, wooden with unpainted, natural finish

**LE1.3 LE2.2**  
Woodland block, woodland edge glades with species rich grassland. Habitat connectivity with Banwell Wood.

**E3.1 E3.2**  
Reptile translocation area

**LE4.4**  
Hedgerow with intermittent hedgerow trees. Placemaking and reinforces setting and connectivity with Banwell Wood.

**LE5.2**  
Bat hopover to guide flightline

**E2.1, LE6.4**  
Pond 7 Attenuation basin with species rich marshy grassland

**E3.2**  
Attenuation basin surrounds enhancement. Reptile enhancement, habitat piles and refugia.

**LE1.3 LE2.2 LE4.4**  
Woodland block planting, species rich grassland providing integration with Banwell Woods. Habitat creation, foraging and roosting potential, pollinators.

**LE1.3 LE2.2**  
Woodland block, woodland edge glades with species rich grassland. Habitat connectivity with Banwell Wood.

**P1.1**  
Mendip Hills AONB

**LE1.3 LE2.2**  
Woodland block, woodland edge glades with species rich grassland. Habitat connectivity with Banwell Wood.

**P1.1**  
North Somerset and Mendip Bats SAC

**NOTES:**

Landscape Element (LE)  
Environmental Element (EE)  
Planning & Policy Feature (P)

**ENVIRONMENTAL FUNCTIONS:**

EFA Visual Screening  
EFB Landscape Integration  
EFC Enhancing the Built Environment  
EFD Nature Conservation & Biodiversity  
EFE Visual Amenity  
EFF Heritage  
EFG Auditory Amenity  
EFH Water Quality  
EFJ Agricultural / Highway Boundary  
EFK Access / Landscape Management  
EFL Scattered trees - orchard trees  
EFM Heavy standard trees

**LANDSCAPE ELEMENTS:**

LE1 Grassland  
LE1.1 Amenity grass areas  
LE1.2 Scattered Trees  
LE1.3 Grassland with bulbs  
LE1.3 Species Rich (or Conservation) Grassland  
LE1.3 Meadow management (Conservation grazing)  
LE1.3 Compound area - Reinstatement grass  
LE1.3 Scattered trees - orchard trees  
LE1.3 Reinstatement grass  
LE1.3 Woodland  
LE2 Woodland Edge  
LE2.1 Scattered Trees  
LE2.2 Scrub  
LE2.3 Retained Hedgerows  
LE2.4 Native Species Hedgerows  
LE2.4 Native Hedgerows with Trees  
LE2.5 Individual Trees  
LE2.6 Watercourse/Drains  
LE3 Marsh and Wet Grassland  
LE3.1 Traditional orchard  
LE3.2 Retained tree(s) of note  
LE3.3 Hard Landscape  
LE3.4 Retaining wall  
LE3.5 PRow  
LE3.6 PRow (Diversions)  
LE3.7 Mammal crossing provision  
LE3.8 Protected species fencing

**ENVIRONMENTAL ELEMENTS**

**E1 NOISE**  
E1.1 Noise reducing surfaces  
E1.2 Noise Barrier built elements  
E2 WATER  
E2.1 Water Pollution Control Measures  
E2.2 Surface Water Outfalls  
E3 NATURE CONSERVATION & BIODIVERSITY  
E3.1 Protected Species  
E3.2 Ecological Protection Measures  
E4 PESTS & INJURIOUS WEEDS  
E4.1 Injurious weeds  
E4.2 Legislated Pests

**PLANNING AND POLICY FEATURES**

**P1 NATURE CONSERVATION DESIGNATIONS**  
P1.1 Statutory nature conservation designation  
P1.2 Non-statutory designation  
**P2 LANDSCAPE DESIGNATION**  
P2.1 Statutory designation  
P2.2 Local Landscape designation  
P3 CULTURAL HERITAGE  
P3.1 Cultural Heritage Feature  
P3.2 Conservation Area  
P4 LAND USE  
P4.1 Agricultural Land  
P4.3 Public Open Space  
P4.4 Public Rights of Way  
**P6 WATER QUALITY**  
P6.1 Watercourse Quality  
P6.2 Areas of Ground Water Sensitivity

**NOTES:**

1. ALL DIMENSIONS ARE IN METRES UNLESS NOTED OTHERWISE.  
2. ONLY WRITTEN DIMENSIONS SHALL BE USED, DO NOT SCALE.

**SCHEME ELEMENTS:**

Scheme - On embankment  
Scheme - In cutting  
Swale  
Shared use path (3m wide unless labelled otherwise)  
Existing vegetation (Woodland)  
Existing vegetation (Hedgerow)  
Attenuation basin  
Flood Compensation Area

AONB Area of Outstanding Natural Beauty  
SAC Special Area of Conservation  
SNCI Site of Nature Conservation Importance  
SSSI Site of Special Scientific Interest  
TPO Tree Preservation Order  
PMA Private Means of Access  
PRow Public Right of Way

**FOR RED LINE BOUNDARY AND ESSENTIAL MITIGATION BOUNDARY REFER TO GENERAL ARRANGEMENT DRAWINGS BNWLB-ARP-HGN-X\_BB\_Z-DR-CH-000001 TO 000006**

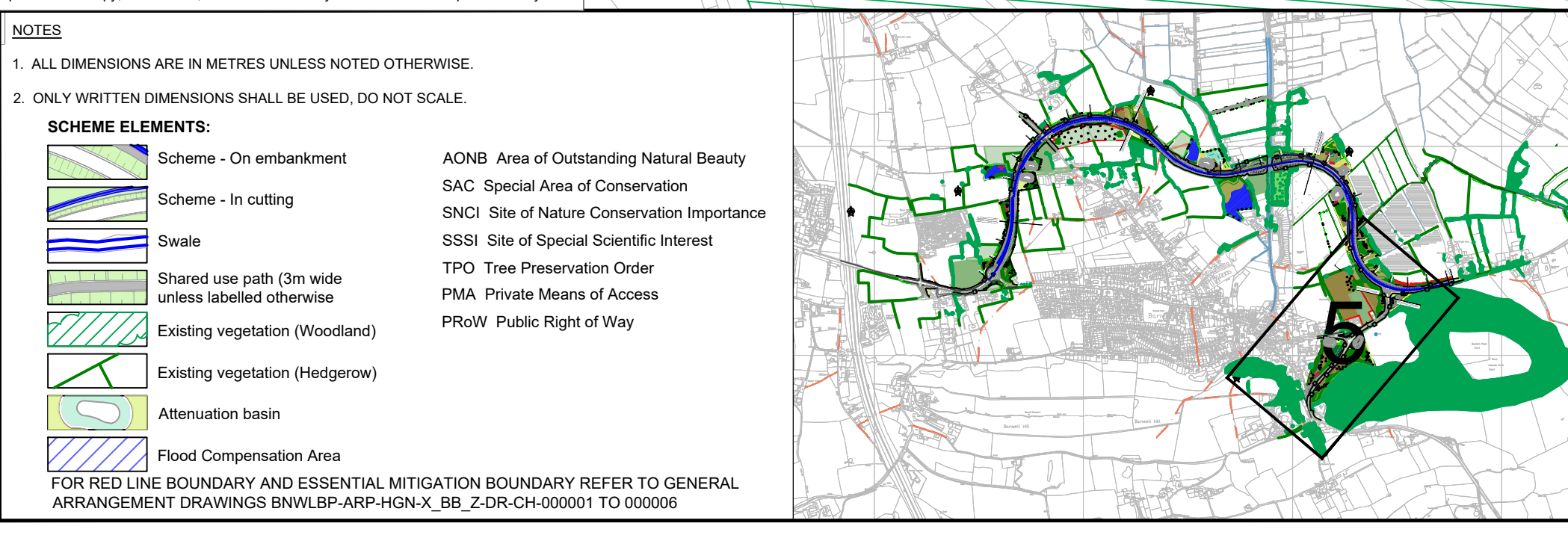

**SAFETY, HEALTH AND ENVIRONMENTAL INFORMATION**

IN ADDITION TO THE HAZARDS/RISKS NORMALLY ASSOCIATED WITH THE TYPES OF WORK DETAILED ON THIS DRAWING, NOTE THE FOLLOWING SIGNIFICANT RESIDUAL RISKS (REFERENCE SHALL ALSO BE MADE TO THE DESIGN HAZARD LOG)

REF NO.	DESCRIPTION	STATUS	DATE	BY	CHK'D	APP'D	AUTH'D
P01	FIRST ISSUE	Y	03/03/22	SD	TE	RW	
P02	SECOND ISSUE	Y	21/08/22	LC	AC	RW	
P03	THIRD ISSUE	LC	24/09/22	SD	AC	MJ	
P04	FOURTH ISSUE	LC	05/07/22	JW	TE	MJ	
P05	ISSUE FOR PLANNING	LC	12/07/22	SD	TE	MJ	
P06	UPDATE TO COMMENTS	Y	12/09/22	SD	AC	RW	
P07	DESIGN UPDATES	Y	18/10/22	SD	JW	---	
P08	UPDATED FOLLOWING PLANNING CONSULTATION	SD	14/12/22	JP	TE	MJ	

CONSTRUCTION  
REF NO. (TO BE POPULATED)

MAINTENANCE / CLEANING  
REF NO. (TO BE POPULATED)

USE  
REF NO. (TO BE POPULATED)

DECOMMISSIONING / DEMOLITION  
REF NO. (TO BE POPULATED)

Suitability Drawing Status  
**S8 FOR PLANNING APPLICATION**

**GRIFFITHS**  
civil engineering and construction

**ARUP** **TACP**

Client: **North Somerset COUNCIL**

Project Title: **BANWELL BYPASS AND HIGHWAY IMPROVEMENTS**

Drawing Title: **ENVIRONMENTAL MASTERPLAN SHEET 5 OF 6**

Scale	1:1250	By	SD	Checked	JP	Approved	TE	Authorised	MJ
Original Size	A1	Date	14/12/22	Date	14/12/22	Date	14/12/22	Date	14/12/22

Drawing Number: **BNWLB - TACP - ELS - X\_BB\_Z - DR - LE - 000014**

Project: **BNWLB - TACP - ELS - X\_BB\_Z - DR - LE - 000014**

Volume: **-DR-LE-000014**

Location: **P08**

Location Type Role Number



100  
0 10  
Millimetres

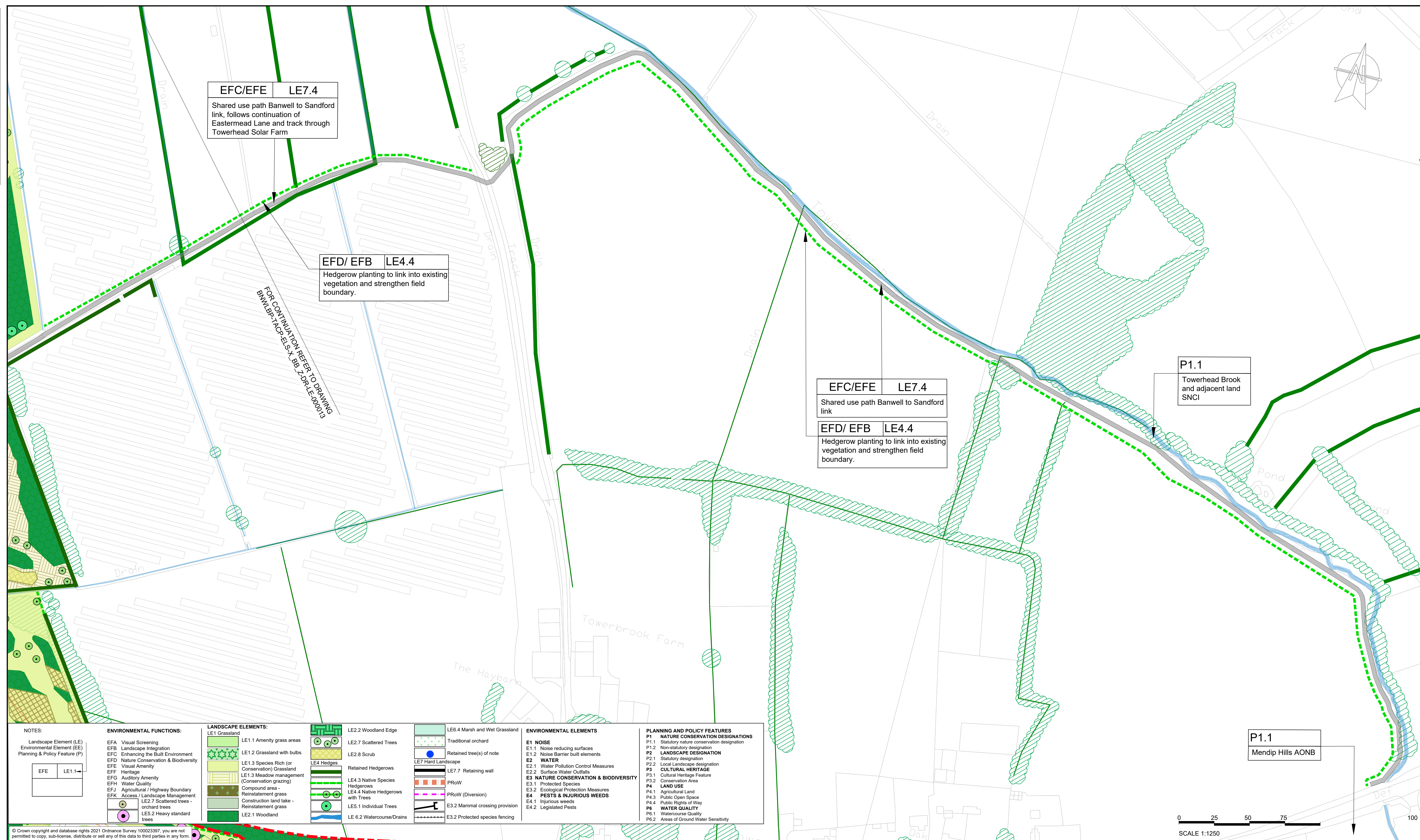

**EFC/EFE LE7.4**  
Shared use path Banwell to Sandford link, follows continuation of Eastermead Lane and track through Towerhead Solar Farm

**EFD/EFB LE4.4**  
Hedgerow planting to link into existing vegetation and strengthen field boundary.

**EFC/EFE LE7.4**  
Shared use path Banwell to Sandford link

**EFD/EFB LE4.4**  
Hedgerow planting to link into existing vegetation and strengthen field boundary.

**P1.1**  
Towerhead Brook and adjacent land SNCI

**P1.1**  
Mendip Hills AONB

FOR CONTINUATION REFER TO DRAWING  
BNWLBP-ARP-EL-X\_BB\_Z-DR-LE-000015

NOTES:	ENVIRONMENTAL FUNCTIONS:	LANDSCAPE ELEMENTS:	ENVIRONMENTAL ELEMENTS	PLANNING AND POLICY FEATURES
<p>Landscape Element (LE)</p> <p>Environmental Element (EE)</p> <p>Planning &amp; Policy Feature (P)</p> <p>EFE LE1.1</p>	<p>EFA Visual Screening</p> <p>EFB Landscape Integration</p> <p>EFC Enhancing the Built Environment</p> <p>EFD Nature Conservation &amp; Biodiversity</p> <p>EFE Visual Amenity</p> <p>EFF Heritage</p> <p>EFG Auditory Amenity</p> <p>EFH Water Quality</p> <p>EFJ Agricultural / Highway Boundary</p> <p>EFK Access / Landscape Management</p> <p>LE2.7 Scattered trees - orchard trees</p> <p>LE2.2 Heavy standard trees</p>	<p>LE1 Grassland</p> <p>LE1.1 Amenity grass areas</p> <p>LE1.2 Grassland with bulbs</p> <p>LE1.3 Species Rich (or Conservation) Grassland</p> <p>LE1.3 Meadow management (Conservation grazing)</p> <p>Compound area - Reinstatement grass</p> <p>Construction land take - Reinstatement grass</p> <p>LE2.1 Woodland</p> <p>LE2.2 Woodland Edge</p> <p>LE2.7 Scattered Trees</p> <p>LE2.8 Scrub</p> <p>LE4 Hedges</p> <p>Retained Hedgerows</p> <p>LE4.3 Native Species Hedgerows</p> <p>LE4.4 Native Hedgerows with Trees</p> <p>LE5.1 Individual Trees</p> <p>LE 6.2 Watercourse/Drains</p> <p>LE6.4 Marsh and Wet Grassland</p> <p>Traditional orchard</p> <p>Retained tree(s) of note</p> <p>LE7 Hard Landscape</p> <p>LE7.7 Retaining wall</p> <p>PrOw</p> <p>PrOw (Diversion)</p> <p>E3.2 Mammal crossing provision</p> <p>E3.2 Protected species fencing</p>	<p><b>E1 NOISE</b></p> <p>E1.1 Noise reducing surfaces</p> <p>E1.2 Noise Barrier built elements</p> <p><b>E2 WATER</b></p> <p>E2.1 Water Pollution Control Measures</p> <p>E2.2 Surface Water Outfalls</p> <p><b>E3 NATURE CONSERVATION &amp; BIODIVERSITY</b></p> <p>E3.1 Protected Species</p> <p>E3.2 Ecological Protection Measures</p> <p><b>E4 PESTS &amp; INJURIOUS WEEDS</b></p> <p>E4.1 Injurious weeds</p> <p>E4.2 Legistated Pests</p>	<p><b>P1 NATURE CONSERVATION DESIGNATIONS</b></p> <p>P1.1 Statutory nature conservation designation</p> <p>P1.2 Non-statutory designation</p> <p><b>P2 LANDSCAPE DESIGNATION</b></p> <p>P2.1 Statutory designation</p> <p>P2.2 Local Landscape designation</p> <p><b>P3 CULTURAL HERITAGE</b></p> <p>P3.1 Cultural Heritage Feature</p> <p>P3.2 Conservation Area</p> <p><b>P4 LAND USE</b></p> <p>P4.1 Agricultural Land</p> <p>P4.3 Public Open Space</p> <p>P4.4 Public Rights of Way</p> <p><b>P6 WATER QUALITY</b></p> <p>P6.1 Watercourse Quality</p> <p>P6.2 Areas of Ground Water Sensitivity</p>

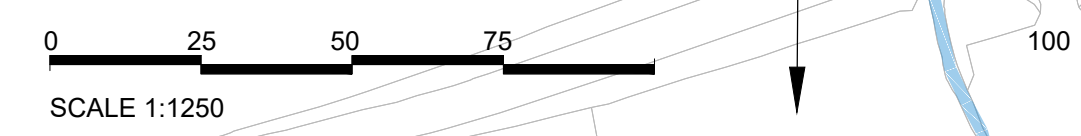

NOTES:

- ALL DIMENSIONS ARE IN METRES UNLESS NOTED OTHERWISE.
- ONLY WRITTEN DIMENSIONS SHALL BE USED, DO NOT SCALE.

**SCHEME ELEMENTS:**

	Scheme - On embankment		AONB Area of Outstanding Natural Beauty
	Scheme - In cutting		SAC Special Area of Conservation
	Swale		SNCI Site of Nature Conservation Importance
	Shared use path (3m wide unless labelled otherwise)		SSSI Site of Special Scientific Interest
	Existing vegetation (Woodland)		TPO Tree Preservation Order
	Existing vegetation (Hedgerow)		PMA Private Means of Access
	Attenuation basin		PrOw Public Right of Way
	Flood Compensation Area		

FOR RED LINE BOUNDARY AND ESSENTIAL MITIGATION BOUNDARY REFER TO GENERAL ARRANGEMENT DRAWINGS BNWLBP-ARP-HGN-X\_BB\_Z-DR-CH-000001 TO 000006

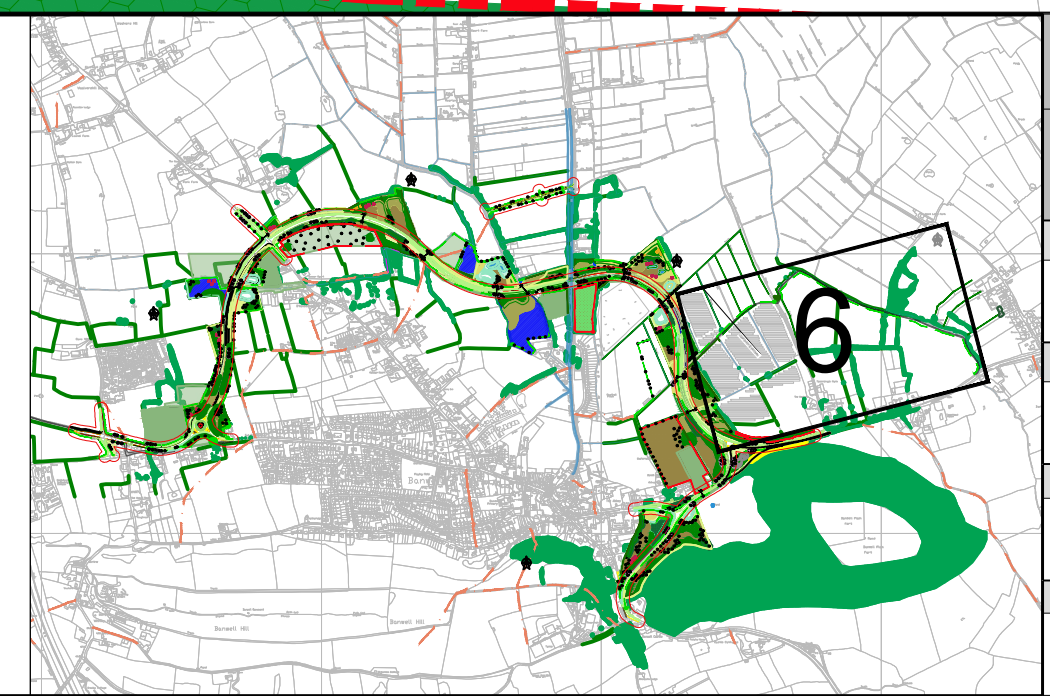

**SAFETY, HEALTH AND ENVIRONMENTAL INFORMATION**

IN ADDITION TO THE HAZARDS/RISKS NORMALLY ASSOCIATED WITH THE TYPES OF WORK DETAILED ON THIS DRAWING, NOTE THE FOLLOWING SIGNIFICANT RESIDUAL RISKS (REFERENCE SHALL ALSO BE MADE TO THE DESIGN HAZARD LOG)

CONSTRUCTION	MAINTENANCE / CLEANING	USE	DECOMMISSIONING / DEMOLITION
REF NO. (TO BE POPULATED)	REF NO. (TO BE POPULATED)	REF NO. (TO BE POPULATED)	REF NO. (TO BE POPULATED)

Rev.	Date	Description	By	Chk'd	App'd	Auth'd
P01	06/07/22	FIRST ISSUE	LC	SD	TE	MJ
P02	12/07/22	ISSUE FOR PLANNING	LC	SD	TE	MJ
P03	14/12/22	UPDATED FOLLOWING PLANNING CONSULTATION	SD	JP	TE	MJ

Suitability: **S8** Drawing Status: **FOR PLANNING APPLICATION**

**GRIFFITHS**  
civil engineering and construction

**ARUP** **TACP**

Client: **North Somerset COUNCIL**

Project Title		<b>BANWELL BYPASS AND HIGHWAY IMPROVEMENTS</b>			
Drawing Title		<b>ENVIRONMENTAL MASTERPLAN SHEET 6 OF 6</b>			
Scale	By	Checked	Approved	Authorised	
1:1250	SD	JP	TE	MJ	
Original Size	Date	Date	Date	Date	
A1	14/12/22	14/12/22	14/12/22	14/12/22	
Drawing Number	Project	Originator	Volume	Revision	
	BNWLBP - TACP - ELS			P03	
	X_BB_Z -DR-LE-000015				
Location	Type	Role	Number		